



# **Bigger Beechworth Project**

November 2009

## Baarmutha Park Master Plan

### Attachment 2

# Baarmutha Park Masterplan

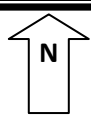

Beechworth golf course re- development as per Golf Club Strategic plan 2009-13.

Improve tree management and formal risk management signage and practices.

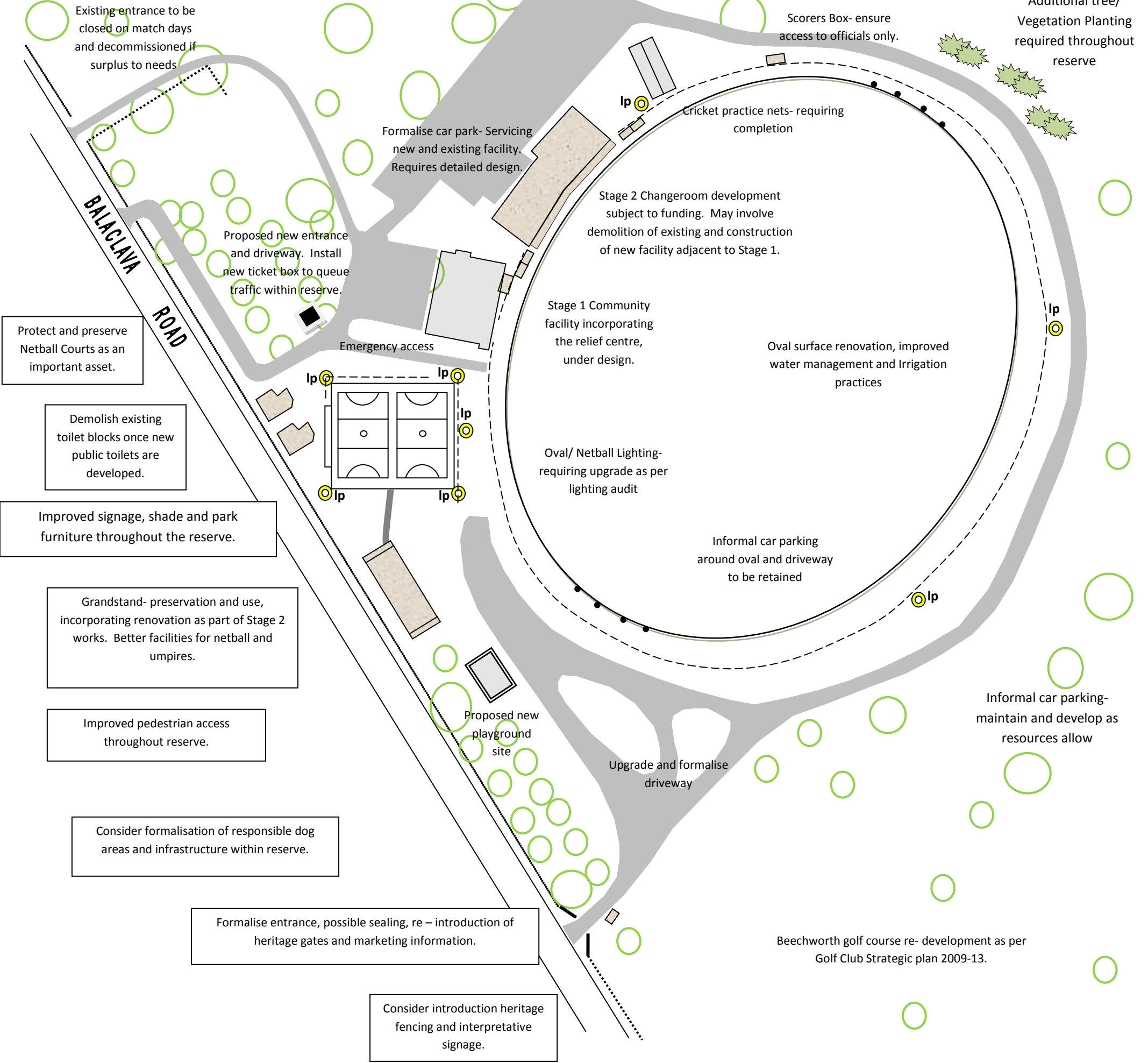
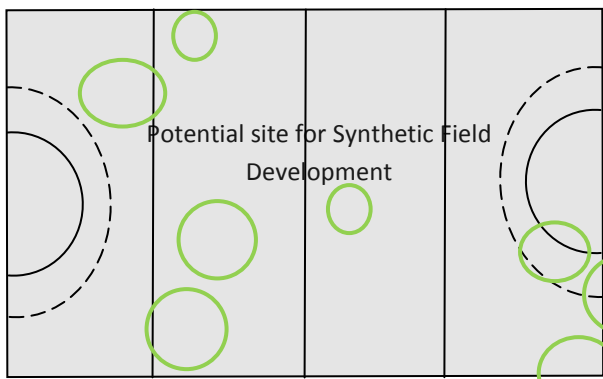

Existing entrance to be closed on match days and decommissioned if surplus to needs

Scorers Box- ensure access to officials only.

Additional tree/ Vegetation Planting required throughout reserve

Formalise car park- Servicing new and existing facility. Requires detailed design.

Cricket practice nets- requiring completion

Proposed new entrance and driveway. Install new ticket box to queue traffic within reserve.

Stage 2 Changeroom development subject to funding. May involve demolition of existing and construction of new facility adjacent to Stage 1.

Protect and preserve Netball Courts as an important asset.

Stage 1 Community facility incorporating the relief centre, under design.

Oval surface renovation, improved water management and Irrigation practices

Demolish existing toilet blocks once new public toilets are developed.

Oval/ Netball Lighting- requiring upgrade as per lighting audit

Improved signage, shade and park furniture throughout the reserve.

Informal car parking around oval and driveway to be retained

Grandstand- preservation and use, incorporating renovation as part of Stage 2 works. Better facilities for netball and umpires.

Informal car parking- maintain and develop as resources allow

Improved pedestrian access throughout reserve.

Proposed new playground site

Upgrade and formalise driveway

Consider formalisation of responsible dog areas and infrastructure within reserve.

Formalise entrance, possible sealing, re – introduction of heritage gates and marketing information.

Consider introduction heritage fencing and interpretative signage.

Beechworth golf course re- development as per Golf Club Strategic plan 2009-13.

Partnership development, support for volunteers and increased use of the reserve are all key elements of the masterplan.

Further development and effective utilisation of water harvesting system.

